



121-08-1/121-36-1

Chave de caixa 1/2" sextavada



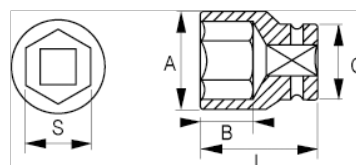

DETALHES DO PRODUTO

- Chaves de caixa sextavadas de 1/2" em mm
- Aço de liga de cromo vanádio
- Acabamento cromado brilhante
- Perfil em formato de onda NPP
- Normas: DIN3120, DIN3124



ATRIBUTOS DO PRODUTO

| Produto |  | A | B | C | L |  |
|-----------------|---|----------|----------|----------|----------|---|
| 121-08-1 | 8 mm | 14.8 mm | 13 mm | 22 mm | 38 mm | 50 g |
| 121-09-1 | 9 mm | 15.3 mm | 13 mm | 22 mm | 38 mm | 48 g |
| 121-10-1 | 10 mm | 15.3 mm | 13 mm | 22 mm | 38 mm | 49 g |
| 121-11-1 | 11 mm | 16.5 mm | 13 mm | 22 mm | 38 mm | 50 g |
| 121-12-1 | 12 mm | 17.8 mm | 13 mm | 22 mm | 38 mm | 52 g |
| 121-13-1 | 13 mm | 19 mm | 13 mm | 22 mm | 38 mm | 54 g |
| 121-14-1 | 14 mm | 20.3 mm | 13 mm | 22 mm | 38 mm | 56 g |
| 121-15-1 | 15 mm | 22 mm | 17.8 mm | 20.5 mm | 38 mm | 57 g |
| 121-16-1 | 16 mm | 22 mm | 17.8 mm | 20.5 mm | 38 mm | 71 g |
| 121-17-1 | 17 mm | 24 mm | 17.8 mm | 21.9 mm | 38 mm | 72 g |
| 121-18-1 | 18 mm | 25 mm | 17.8 mm | 22.9 mm | 38 mm | 90 g |
| 121-19-1 | 19 mm | 26 mm | 17.8 mm | 22.9 mm | 38 mm | 84 g |
| 121-20-1 | 20 mm | 28 mm | 17.8 mm | 23.9 mm | 38 mm | 87 g |
| 121-21-1 | 21 mm | 28 mm | 17.8 mm | 23.9 mm | 38 mm | 95 g |
| 121-22-1 | 22 mm | 30 mm | 17.8 mm | 26.1 mm | 38 mm | 97 g |
| 121-23-1 | 23 mm | 32 mm | 17.8 mm | 28.1 mm | 38 mm | 103 g |
| 121-24-1 | 24 mm | 32 mm | 17.8 mm | 28.1 mm | 38 mm | 109 g |
| 121-25-1 | 25 mm | 34 mm | 17.8 mm | 29.1 mm | 40 mm | 146 g |
| 121-26-1 | 26 mm | 34 mm | 17.8 mm | 29.1 mm | 42 mm | 192 g |
| 121-27-1 | 27 mm | 36 mm | 17.8 mm | 30.1 mm | 42 mm | 211 g |
| 121-28-1 | 28 mm | 38 mm | 17.8 mm | 32.1 mm | 42 mm | 212 g |
| 121-30-1 | 30 mm | 40 mm | 17.8 mm | 34.1 mm | 44 mm | 214 g |
| 121-32-1 | 32 mm | 42 mm | 17.8 mm | 36.1 mm | 44 mm | 217 g |
| 121-34-1 | 34 mm | 50 mm | 18 mm | 38 mm | 44 mm | 260 g |
| 121-36-1 | 36 mm | 52 mm | 18.2 mm | 40 mm | 45 mm | 300 g |