



7314-1/2

Cabeça para chave dinamométrica  
1/2" 14X18 com roquete





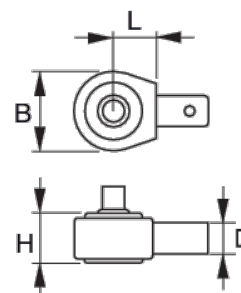

#### DETALHES DO PRODUTO

- Roquete reversível com 45 dentes/8° de ação angular
- A inserção é fixada à chave dinamométrica por um pino retrátil com mola
- Liga de aço de alto desempenho

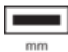

## ATRIBUTOS DO PRODUTO

| Produto         |  |  |  | <b>H</b> | <b>B</b> |  |  |
|-----------------|---|---|---|----------|----------|---|---|
| <b>7314-1/2</b> | 1/2" mm   | 14x18 mm  | 420 N·m   | 20 mm    | 40 mm    | 25 mm   | 265 g   |