



7309-1/4-1/2

Spärrhuvud, 9x12 fäste





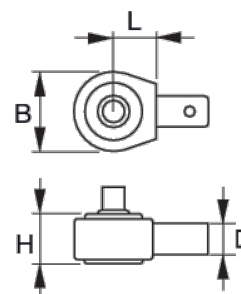

PRODUKTINFORMATION

- Spärrhuvud med 45 tänder och 8° omtagsvinkel
- Insticksverktygsfäste med fjäderbelastat stiftfäste
- Högkvalitativ stållegering

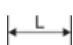

PRODUKTATTRIBUT

Produkt				H	B		
7309-1/4	1/4" mm	9x12 mm	25 N·m	20 mm	37 mm	18 mm	135 g
7309-3/8	3/8" mm	9x12 mm	160 N·m	20 mm	38 mm	18 mm	160 g
7309-1/2	1/2" mm	9x12 mm	160 N·m	20 mm	38 mm	18 mm	160 g