



7314-1/2

Spärrhuvud 14x18 fäste





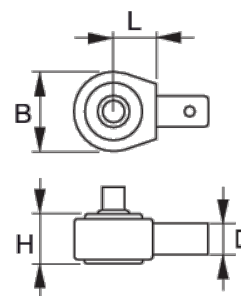

PRODUKTINFORMATION

- Spärrhuvud med 45 tänder och 8° omtagsvinkel
- Insticksverktygsfäste med fjäderbelastat stiftfäste
- Högkvalitativ stållegering

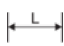

PRODUKTATTRIBUT

| Produkt |  |  |  | H | B |  |  |
|----------|---|---|---|----------|----------|---|---|
| 7314-1/2 | 1/2" mm | 14x18 mm | 420 N·m | 20 mm | 40 mm | 25 mm | 265 g |